

E Hillsdale Blvd - Bike Lane Installation Signage & Striping Plan

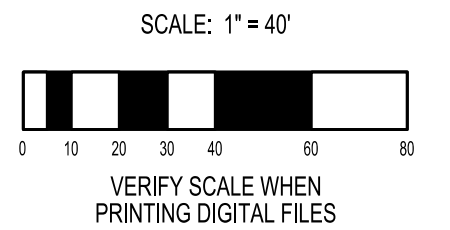

Scale: 1" = 40'

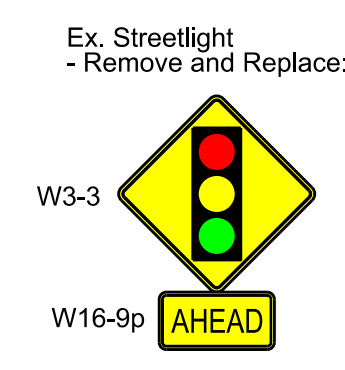

Ex. Streetlight - Remove and Replace:

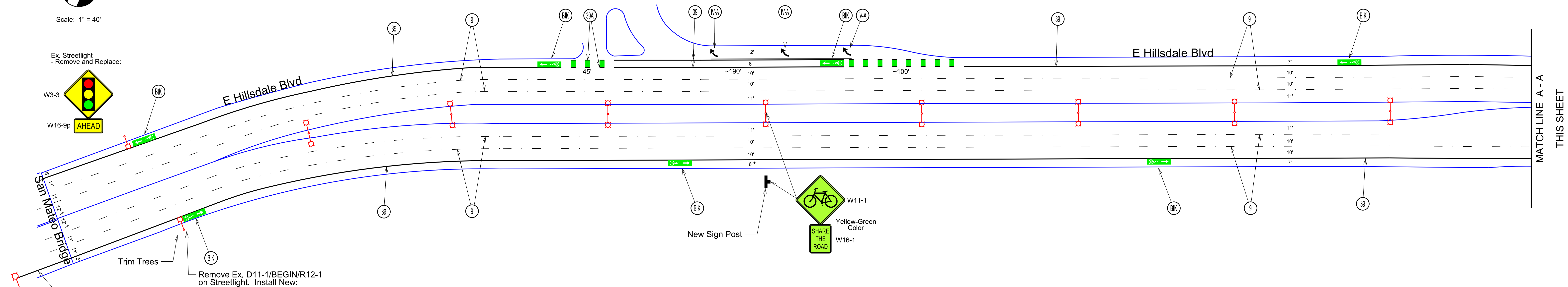

Notes:

- Contractor shall remove, via grinding method, any roadway markings and pavement legends within the slurry seal portion of the project or that are in conflict with this plan prior to installation of new slurry seal.
- All new roadway markings and pavement legends shall be thermoplastic unless noted otherwise.
- Contractor shall submit product material cut sheets for proposed green bike products. Greenback bike lane stencils and greenback sharrows shall be preformed thermoplastic Pre-Mark by Ennis-Flint or approved equal. Continuous section green bike lane areas require product cut sheet approval prior to procurement and installation.
- Contractor shall submit product material cut sheets, with size details, for all new standard highway signs. The Contractor shall be responsible for field verifying the size of signs that are identified for removal and replacement.

STRIPING LEGEND							
IDEN-TIFIER	STRIPING ELEMENT	IDEN-TIFIER	STRIPING ELEMENT	IDEN-TIFIER	STRIPING ELEMENT	IDEN-TIFIER	STRIPING ELEMENT
(2)	STATE DETAIL 2	(31)	STATE DETAIL 31	(40)	SOLID 24" BIKE GREEN	(1A)	TYPE I ARROW - 18"
(9)	STATE DETAIL 9	(32)	STATE DETAIL 32	(8)	SOLID 8" WHITE	(1A)	TYPE IV ARROW (DIRECTION SHOWN)
(22)	STATE DETAIL 22	(38)	STATE DETAIL 38	(10)	SOLID 12" WHITE	(1A)	TYPE VI ARROW
(23)	STATE DETAIL 23	(38B)	STATE DETAIL 38B	(10)	SOLID 24" WHITE	(1A)	TYPE VIA ARROW (DIRECTION SHOWN)
(24)	STATE DETAIL 24	(39)	STATE DETAIL 39	(12)	SOLID 12" YELLOW	(20)	GREENBACK SHARED LANE MARKING MUTCD FIGURE 9C-3 (4'X10')
(26)	STATE DETAIL 26 - Use 20' Spacing	(39A)	STATE DETAIL 39A	(14)	SOLID 24" YELLOW	(20)	GREENBACK BIKE LANE STENCIL WITH STRAIGHT ARROW MUTCD FIGURE 9C-3(B)
(27B)	STATE DETAIL 27B	(4)	STATE DETAIL 40	(15S)	PAVEMENT MESSAGE (MESSAGE SHOWN)	(20)	BIKE LOOP DETECTOR STENCIL
(28)	STATE DETAIL 28	(41)	STATE DETAIL 41				
(29)	STATE DETAIL 29						

*All new Bicycle Facility Markings and Legends shall be Preformed Thermoplastic as Manufactured by Ennis-Flint or Approved Equal

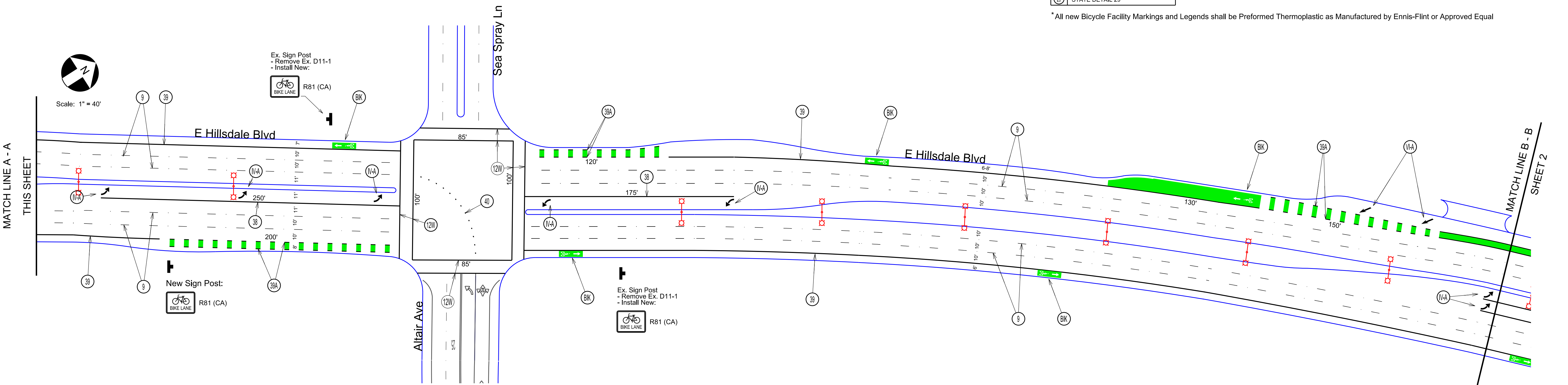

Traffic Patterns
 P.O. Box 25
 Danville, CA 94526
 O: (408) 916-8141
 www.trafficpatterns.net
 info@trafficpatterns.net

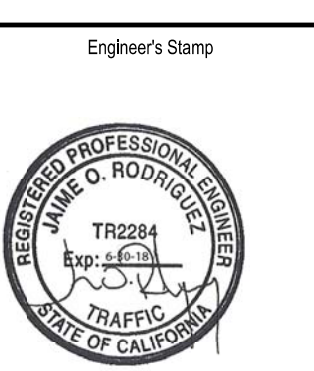

Record Drawings

Project Engineer: _____ Date: _____

Designer: _____ Date: _____

Public Works Inspector: _____ Date: _____

Public Improvements Initially Accepted by the City Council on: _____

Submittal Log

NO.	DESCRIPTION	DATE
1	BID SET	2-23-18

DRAWN BY: J. Rodriguez Date: 2-15-18

CHECKED BY: City of Foster City Date: 2-15-18

DESIGNED BY: J. Rodriguez Date: 2-15-18

Revisions

NO.	DESCRIPTION	DATE

City of Foster City
 CIP 301-671
 Bicycle and Pedestrian Improvements
 along
 East Hillsdale Boulevard and Beach Park Boulevard
 Signage and Striping Plan

RECOMMENDED FOR BIDDING BY: _____ DATE: _____

APPROVED FOR BIDDING BY: _____ DATE: _____

PROJECT NO. _____

DRAWING NO. 4 of 13

E.P. NO. _____

SCALE 1" = 40'

SS-1